



# STUTTERHEIM

PURE PLEASURE

Aspire, the economic development agency of the Amathole District Municipality, in close cooperation with Amahlathi Municipality, secured funds from National Treasury for the economic regeneration of Stutterheim and its surrounds. To date three infrastructure upgrade projects are changing the face of the town.

The construction of a new bridge and road linking Stutterheim town and Mlungisi is complete and open for traffic. Final clearance of the site is underway and new street lights have been ordered to increase pedestrian safety at night. A pedestrian walkway leads all the way up to Mlungisi to promote safe walking. The bridge having being entirely built out of bricks in an old style to maximize the use of local labour during construction, is a new beautiful feature in town.



*Proposed design of Grey Square*



A facelift for Stutterheim, the gateway to the Amathole mountain range, was identified as a priority intervention. The intention is to increase the town's appeal for residents and visitors, as well making it more user friendly for pedestrians, vehicles and taxis. The upgrade officially started on the 18 July

2011 and is estimated to be completed around April 2012. The area to be upgraded includes the roads within the CBD with the highest concentration of pedestrian traffic and commercial activity; areas along the two main roads - McLean and Hill Streets, the intersection at Grey Square and the main taxi rank and immediate surrounds. Work to be undertaken will include: repair and new paving on pavements, new benches and trees, extension of the existing taxi rank, and partial closure of Hill Street, repair and upgrade of the north half of Grey Square and its closure for vehicular traffic, improvement of facilities for informal traders, public toilet facilities, and street lighting upgrade.

Stutterheim is also launching its new town brand "Stutterheim – Pure Pleasure". The brand was developed via a public community campaign where people from Stutterheim were asked: What is Stutterheim to you? The poems and stories submitted from a variety of residents told the story of the town and what it means to its population. It became evident that "Stutterheim is the sanctuary of rich, natural hospitality that is expressed through its essential beauty and its spirited people" In short: Stutterheim is **PURE PLEASURE**.

Construction of a community commercial park at Mlungisi is kicking off to provide a variety of services to Mlungisi residents



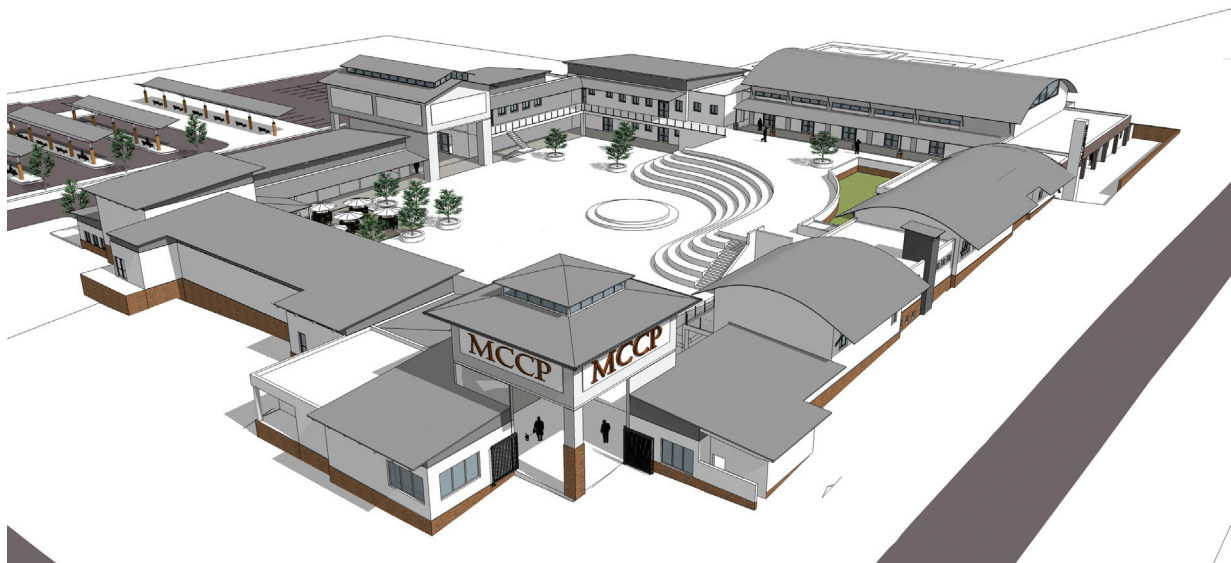

Community Commercial Park at Mlungisi

and surrounding areas. These include a satellite post office and police station; a municipal paypoint; library, multipurpose community hall; LoveLife youth centre and clinic; pharmacy; entertainment areas including an amphitheatre, sports fields and gym; and retail shops such as a supermarket, market area, restaurant, hair salon, hardware store, clothing store amongst others.

Construction will start mid-August 2011 and doors will open to the public

by early 2013. In the interim, lease agreements will be signed and support provided to emerging entrepreneurs who want to take up this business opportunity. This is done in cooperation with the Eastern Cape Development Corporation, the Department of Economic Development and the Small Enterprise Development Agency.

Commercial space is still available for rent. Aspire welcomes tenants or any community initiative that are interested

in providing services such as a cell phone shop; restaurant or take away; insurance services; funeral services outlet or furniture shop.

Looking forward, these initiatives will change the face of Stutterheim and its surrounds for both residents and visitors alike, aiming to live up to the town's brand – **PURE PLEASURE**.



The Community Commercial Park will provide a variety of services to Mlungisi residents.



**national treasury**  
Department:  
National Treasury  
REPUBLIC OF SOUTH AFRICA

#### FOR MORE INFORMATION:

If you would like more information on the regeneration of Stutterheim, Aspire, or the Small Town Regeneration programme please contact:

**Miss Saskia Haardt** at Aspire, Phone 043 7212070 or [saskia@aspire.org.za](mailto:saskia@aspire.org.za)